



## 30D Series

## Sanitary Clamp, Full Port, 3-way Ball Valves (3-A approved)



The Assured Automation 30D Series full port, 3-way Ball valves with sanitary tri-clamp end connections have valve materials, interior finish, and dimensions that comply with 3A and FDA requirements. They are ideal for use in food processing and other clean service applications. They include an ISO 5211 mounting pad for the direct mounting of actuators. Direct mount eliminates the need for extra space, weight, and cost. A full range of accessory items are available including pneumatic and electric actuators, limit switches, solenoid valves, and manual override devices.

### END CONNECTIONS

Sanitary Tri-Clamp: 1/2" to 4"

### MAXIMUM PRESSURE

1000 psi WOG

**Note:** Clamp end is limited by the type of clamp used

[see Pressure/Temperature Curve](#)

### TEMPERATURE RANGE

-4°F to 392°F

[see Pressure/Temperature Curve](#)

### MATERIALS

**Body:** 316 Stainless Steel

**Seats:** PTFE

**Seals:** PTFE

**Port:** Full-port (L shaped bore)

### FEATURES

- Materials, finish, and dimensions comply with 3A and FDA requirements
- Sanitary clamp end connections
- Seats with cavity fillers to prevent media entrapment
- Full port bore
- ISO 5211 direct mount actuator mounting pad
- Blow-out proof stem
- Latch locking handle
- Electric or pneumatic actuators available
- Solenoid valves and limit switches available

### ACTUATORS

#### Pneumatic

- Spring return
- Double Acting

#### Electric

- various IP ratings and voltages
- modulating or on/off

#### Manual handle lever

- Standard lever or lockable

[see page 5 for accessory details](#)

### TYPICAL APPLICATIONS

- Dairy
- Water bottling
- Brewing
- Flavor & fragrance
- Food and Beverage

**Materials, interior finish, and dimensions comply with 3A and FDA requirements**

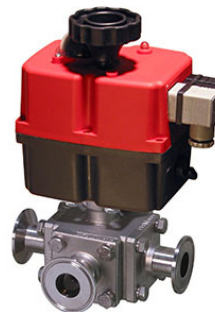



## 30D Series



Sanitary Clamp, Full Port, 3-way Ball Valves (3-A approved)

### PRESSURE/TEMPERATURE CURVE

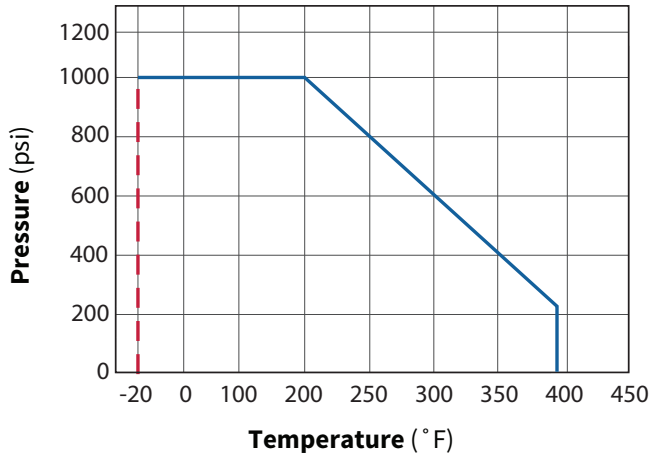

### Cv FLOW COEFFICIENTS

Size	L Port	T-Port (through)	T-Port (branch)
1/2"	4.55	5.57	3.22
3/4"	13.36	16.36	9.45
1"	27.25	33.37	19.27
1 1/2"	70.71	86.6	50.00
2"	138.5	169.63	97.94
2 1/2"	229.32	280.86	162.15
3"	335.17	410.49	237.00
4"	670.00	800.00	475.00

### FLOW PLANS

90° / 2-Position (Standard and typically in-stock - All others are special order)

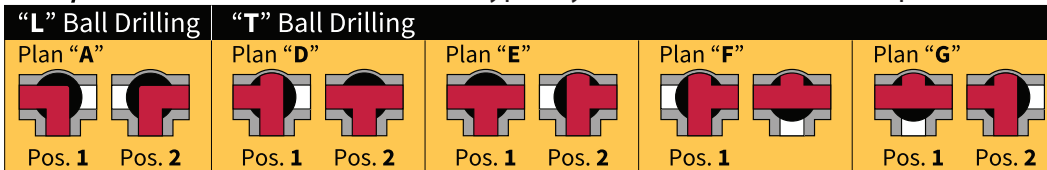

180° / 2-Position

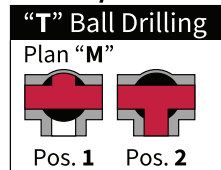

180° / 3-Position

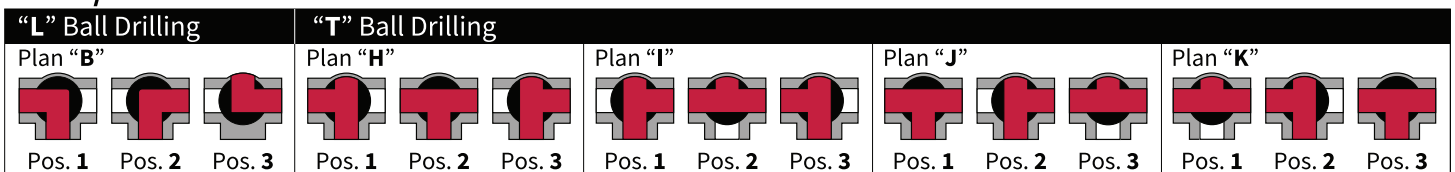

### MATERIALS OF CONSTRUCTION

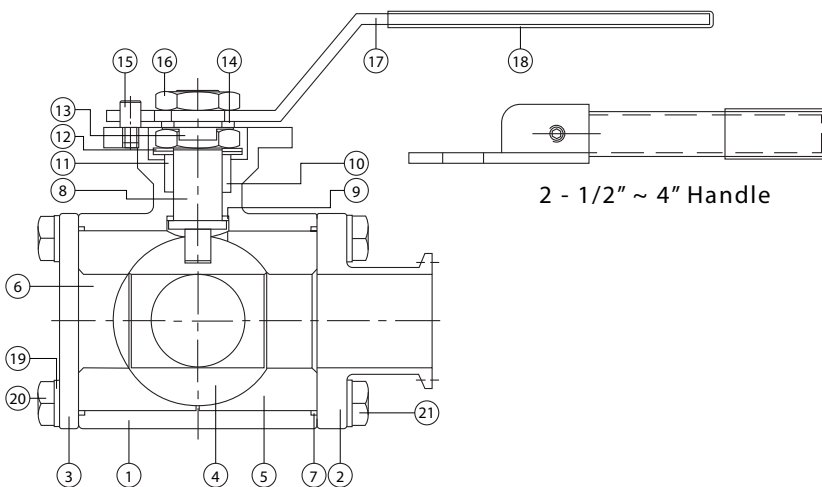

Item	Part	Material
1	BODY	ASTM A351-CF8M
2	CAP	
3	FLAT CAP	
4	BALL	ASTM A351-CF8M
5	SEAT A	PTFE
6	SEAT B	
7	SEAL	PTFE
8	STEM	ASTM A276-316
9	THRUST WASHER	PTFE
10	PACKING	
11	GLAND RING	AISI 304
12	BELLEVILLE WASHER	AISI 301
13	LOCKING WASHER	AISI 304
14	FLAT WASHER	
15	STOP PIN	
16	STEM NUT	
17	HANDLE	PVC
18	HANDLE SLEEVE	
19	SPRING WASHER	AISI 304
20	BOLT A	
21	BOLT B	



## 30D Series



## Sanitary Clamp, Full Port, 3-way Ball Valves (3-A approved)

### ACTUATORS AVAILABLE

A full range of actuators are available to choose from. All sizing is done by Assured Automation to make selecting your assembly easy. Any accessories ordered with the actuator will be installed and tested by our ISO certified facility.

### Pneumatic

#### C Series

Dual Rack and Pinion

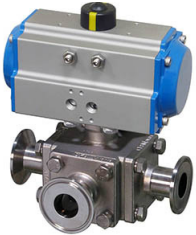

**Spring Return**  
fail to position 1 or 2

**Double Acting**  
fail in place

[\(see C series web page\)](#)

#### P Series

Dual Scotch Yoke



**Spring Return**  
fail to position 1 or 2

**Double Acting**  
fail in place

[\(see P series web page\)](#)

#### F Series

Dual Rack and Pinion



**Spring Return**  
fail to position 1 or 2

**Double Acting**  
fail in place

[\(see F series web page\)](#)

### Accessories

- NAMUR direct mount solenoid valves
- Variety of limit switches
- Modulating positioners
- 1/4" NPT x 1/4" tube push fittings
- 1/4" NPT x 1/4" compression fittings
- SS and poly tubing

### Electric (All have manual override)

#### Weatherproof (NEMA 4/4X)

##### V4 Series



12 or 24 VDC; 120 VAC

- Low-cost industrial
- Epoxy coated alum.
- On/off or modulating

[\(see V4 series web page\)](#)

##### R4 Series



12 or 24 VDC; 120 VAC

- General duty industrial
- Plastic housing
- On/off

[\(see R4 series web page\)](#)

##### S4 Series



24 to 240 VAC/DC

- Auto-voltage sensing
- Battery Failsafe option
- On/off or modulating

[\(see S4 series web page\)](#)

##### K4 Series



120 VAC

- Industrial Worm Gear
- Epoxy coated alum.
- On/off or modulating

[\(see K4 series web page\)](#)

#### Explosion Proof

##### B7 Series



24 VDC and 120 VAC

- Heavy duty industrial
- Epoxy coated alum.
- On/off or modulating

[\(see B7 series web page\)](#)

### Manual

#### Manual Lever



Complete Valve Assembly  
CAD Models & Datasheets  
**ON DEMAND!**



- Complete Specs for Each Component in **ONE Document**
- Dimension Drawings of Exact Assembly

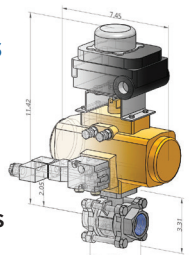



## 30D Series



## Sanitary Clamp, Full Port, 3-way Ball Valves (3-A approved)

### DIMENSIONS (In inches except where noted)

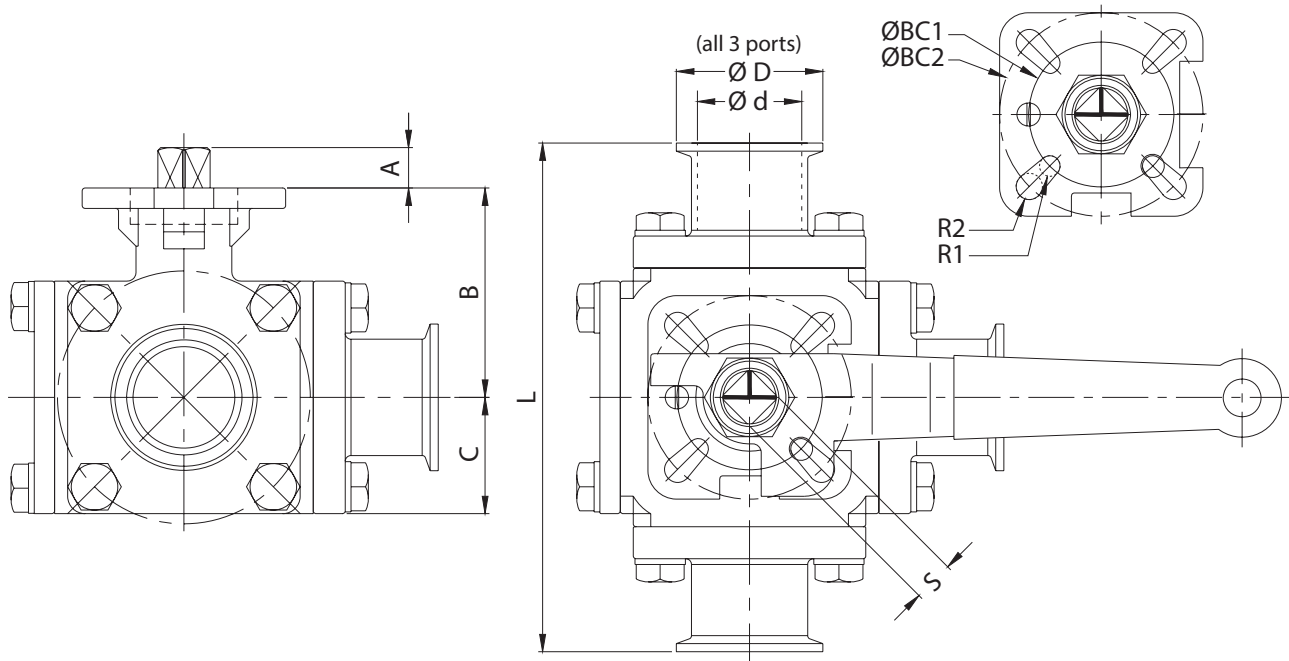

Line Size	A	B	C	ØD	Ød	L	S (mm)	ØBC1	ØBC2	R1	R2	Weight (lbs.)
1/2"	0.35	1.75	0.93	1.00	0.37	4.65	9	1.42	1.65	0.11	0.11	3.5
3/4"	0.35	1.89	1.02	1.00	0.62	5.00	9	1.42	1.65	0.12	0.12	4.2
1"	0.43	2.32	1.20	1.98	0.87	6.00	11	1.65	1.97	0.14	0.14	6.8
1 1/2"	0.55	2.83	1.57	1.98	1.38	6.89	14	1.97	2.76	0.14	0.18	12.6
2"	0.55	3.23	1.97	2.53	1.87	7.48	14	1.97	2.76	0.14	0.18	19.7
3"	0.91	4.94	2.01	3.58	2.87	10.24	22	4.02	4.92	0.22	0.26	44.3
4"	0.70	7.28	4.00	4.59	3.83	13.00	17	2.76	4.02	0.22	0.26	120.0



### Complete Valve Assembly CAD Models & Datasheets ON DEMAND!

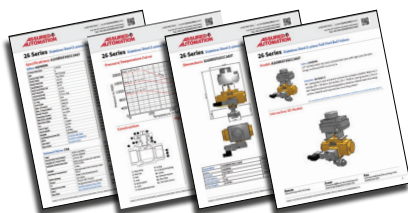

- Complete Specs for Each Component in **ONE Document**
- Dimension Drawings of Exact Assembly

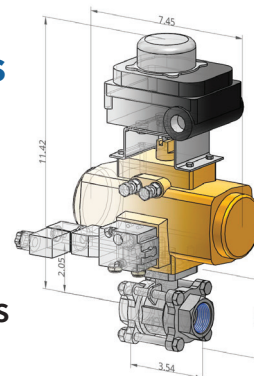



## 30D Series



## Sanitary Clamp, Full Port, 3-way Ball Valves (3-A approved)

### ORDERING INFORMATION

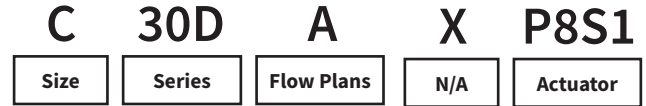

### VALVE BODY

Size: \_\_\_\_\_

- |                   |               |
|-------------------|---------------|
| <b>C</b> = 1/2"   | <b>H</b> = 2" |
| <b>D</b> = 3/4"   | <b>I</b> = 3" |
| <b>E</b> = 1"     | <b>E</b> = 4" |
| <b>F</b> = 1 1/2" |               |

Flow Plans: \_\_\_\_\_

- Plan A**
- Plan D** *(These are Standard and typically in-stock)*
- Plan E** *(Call 1-800-899-0553 for 180° flow plans which are special order)*
- Plan F**
- Plan G**

Note: only one actuator may be chosen

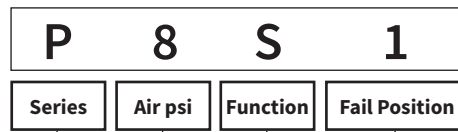

### ACTUATOR

#### Pneumatic Actuators

Series: \_\_\_\_\_

- C** = C Series Dual Rack & Pinion
- P** = P Series Dual Scotch Yoke
- F** = F Series Dual Rack & Pinion

Supply Air Pressure: \_\_\_\_\_

- 6** = 60psi
- 8** = 80psi

Function: \_\_\_\_\_

- S** = Spring return
- D** = Double acting

Fail Safe Position: \_\_\_\_\_

- 1** = Fail to POSITION 1
- 2** = Fail to POSITION 2
- (omit)* for double acting

#### Electric Actuators

Series: \_\_\_\_\_

- V4** = Weatherproof (NEMA 4/4X)
- R4** = Weatherproof (NEMA 4/4X)
- S4** = Weatherproof (NEMA 4/4X Universal Voltage [24 to 240 AC/DC])
- K4** = Weatherproof (NEMA 4/4X)
- B7** = Explosion Proof (NEMA 7)

Voltage: \_\_\_\_\_

- A** = 120VAC
- B** = 24VDC
- F** = 12VDC

#### Manual Operators

Type: \_\_\_\_\_

- M** = Basic Manual Lever

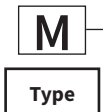
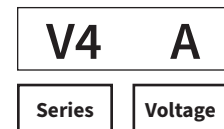

Code continues to specify additional accessories and options



## 30D Series



## Sanitary Clamp, Full Port, 3-way Ball Valves (3-A approved)

### ACCESSORIES

#### Solenoid Valves

NAMUR solenoid valves for direct mount to the actuator. Various coil and connector options are available including weatherproof, explosion proof, corded, NPT conduit, and cable gland.

**3-way**  
for spring return models



**3/4-way for**  
for double acting models



[Solenoid valve web page](#)

#### Limit Switches (valve position indicators)

Used to communicate the position of the valve to a PLC, HMI, or simple remote indicator lamp. Various switch technologies are available. All include a local visual indicator as well.

#### UA/UB Series

Solid state proximity switches; 1 for Open, 1 for Closed

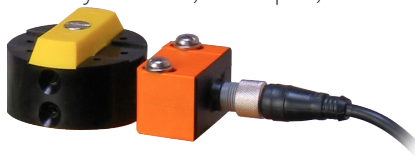

#### YF Series

SPDT mechanical switches; 1 for Open, 1 for Closed

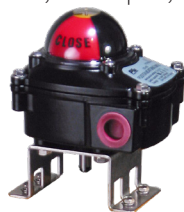

#### YE, YH, YO Series

SPDT mechanical switches; 1 for Open, 1 for Closed



Other limit switches are available [Limit switch web page](#)

#### Modulating Positioners

Add modulating control to either of our pneumatic actuator series. These positioners mount to the top of the actuator using the NAMUR standard mounting hole and stem pattern.

#### Pneumatic

0-15 psi control signal

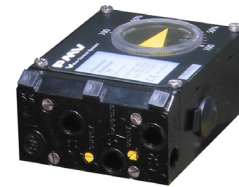

#### Electro-pneumatic

4-20mA or 0-10VDC control signal



#### With feedback unit

4-20mA or 0-10VDC feedback signal



[Positioner web page](#)